

CERTIFIED PRE-OWNED MACHINES

MAY
2026



These machines are thoroughly inspected, repaired, and tested to ensure they meet high standards of functionality and reliability. A certified pre-owned sewing machine is an excellent choice for anyone seeking value, sustainability, and reliable performance.

Every certified pre-owned machine we sell includes a 1-year mechanical warranty* and 30-day unlimited ask warranty.

*See store for details.



**THAT MEANS
BIG SAVINGS
FOR YOU!**

**SEWING & VACUUM
AUTHORITY**

A Family Company

**High Quality
Certified
Pre-Owned
Machines**

*Check back often as
inventory may change*

Bernina 750 QE w/ EMB MOD



The **Bernina 750 QE w/EMB MOD** has tons of space for big projects and quilts with ten inches / 254 mm of space to right of the needle and a super-sized embroidery area. It has a sewing speed of up to 1000 stitches per minute and includes several features of convenience. These include an LED sewing light, a full-color touchscreen, and built-in tips, tricks, and tutorials from the Sewing Consultant. The machine also comes with the Bernina Stitch Regulator, which provides consistent high-speed free-motion stitching assistance with both straight and zigzag stitch options. With the embroidery module for the 750 Quilter's Edition, you can create mirror images, as well as, rotate, size and recolor your selected design right on the touchscreen. You can also preview alternate color options and save them on your machine or USB Stick and use Absolute Check for perfect design placement. This machine was one of the first to include the Bernina 9 hook, which sews high-precision stitches up to 9 mm in width.

Sewing and Vacuum Authority has 2 models in stock, one with an embroidery module and one without.

~~\$6999~~ **\$2299** without Embroidery Module

~~\$9999~~ **\$3399** with Embroidery Module

Contact the store nearest to you to learn more about the certified pre-owned Bernina 750 QE w/EMB MOD we have and enjoy a 1-year mechanical warranty and 30-day unlimited ask warranty on all pre-owned machines today!

Bernina 830



The **Bernina 830** has been a reliable machine that has graced the tabletops and sewing spaces of crafters for years. Now, it's your turn! SVA has one certified pre-owned Bernina 830 sewing, quilting, and embroidery combination machine for sale that offers space for every project, a jumbo bobbin offering a 40% increase on thread capacity for convenience, and the Bernina Stitch Regulator for an even stitch pattern. Use the drag-and-drop editing function for a creative and precise embroidering experience, and never worry about losing the tutorials, as they're built into the touchscreen. The spacious working area extends to 40 cm (15 in) with the free arm leaving 30 cm (12 in) of space to the right of the needle for bigger quilts and projects.

~~\$12000~~ **\$1,999** with Embroidery Module

Contact the store nearest to you to learn more about the certified pre-owned Bernina 830 we have and enjoy a 1-year mechanical warranty and 30-day unlimited ask warranty on all pre-owned machines today!

Bernina 880 Plus



The **Bernina B880 Plus** is the ultimate in sewing, embroidery, and quilting machine. The B880 Plus includes an integrated Stitch Library offering over 1,764 stitches. Each is clearly categorized and stitches are easily retrieved, so you can find any of the 12 font styles and 460 high-quality embroidery designs you need. Enjoy pinpoint placement, enhanced editing functions, total embroidery stitch control, the Bernina Stitch Regulator, and the precise BERNINA Hook that sews high-precision stitches up to 9 mm in width with speeds up to 1,000 stitches per minute.

The extra-large bobbin holds 70% more thread than standard bobbins, so you can keep sewing for longer with the 13-inch free arm and 10 inches of space to the right of the needle. Automatic features included are thread cutting at the end of the seam, semi-auto threading, and auto-lowering of presser foot. Additionally, you'll have access to on-screen support, which provides sewing tips and time-saving advice for the ultimate user experience.

~~\$16499~~ **\$4449**

Contact Quilt Quarters at (317) 757-8340 or visit our store at 9504 Haver Way, Indianapolis, IN 46240 to learn more about this certified pre-owned Bernina 880 Plus and enjoy a 1-year mechanical warranty and 30-day unlimited ask warranty on all pre-owned machines today!

Bernina 880



The **Bernina 880** is a high-performance sewing and embroidery machine packed with advanced features for ultimate creativity and precision. It boasts fully automatic functions, and one of the standout features of the Bernina 880 is its extended freearm, which provides extra space for larger or more complex projects such as quilts and home décor. With an extensive stitch and design library, you can explore a wide range of options, from classic stitches to intricate embroidery, giving you endless possibilities for your sewing and quilting projects.

The modern color touchscreen offers an intuitive interface, ensuring you have full control over your designs with just a tap of your finger. You can now easily customize your projects with the Bernina Color Wheel, Stitch Designer, and Shape Designer, which allow you to create colorful, one-of-a-kind stitches and shapes tailored to your exact specifications.

~~\$13999~~ **\$2995**

Contact the store nearest to you to learn more about the certified pre-owned Bernina 880 we have and enjoy a 1-year mechanical warranty and 30-day unlimited ask warranty on all pre-owned machines today!

Bernina 880



The **Bernina 880** is a high-performance sewing and embroidery machine packed with advanced features for ultimate creativity and precision. It boasts fully automatic functions, and one of the standout features of the Bernina 880 is its extended frearm, which provides extra space for larger or more complex projects such as quilts and home décor. With an extensive stitch and design library, you can explore a wide range of options, from classic stitches to intricate embroidery, giving you endless possibilities for your sewing and quilting projects.

The modern color touchscreen offers an intuitive interface, ensuring you have full control over your designs with just a tap of your finger. You can now easily customize your projects with the Bernina Color Wheel, Stitch Designer, and Shape Designer, which allow you to create colorful, one-of-a-kind stitches and shapes tailored to your exact specifications.

~~\$13999~~ **\$2995**

Contact Quilt Quarters at (317) 757-8340 or visit our store at 9504 Haver Way, Indianapolis, IN 46240 to learn more about the certified pre-owned Bernina 880 we have and enjoy a 1-year mechanical warranty and 30-day unlimited ask warranty on all pre-owned machines today!

Bernina 830 Limited Edition w/ EMB MOD

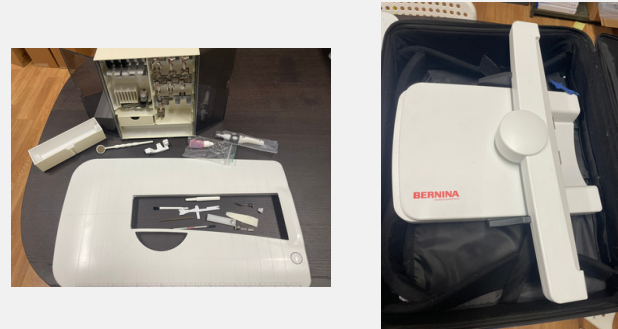

The **Bernina 830 Limited Edition** machine combines advanced technology with a uniquely elegant design for sewing, quilting, and embroidery. With 12 inches of workspace to the right of the needle, it's perfect for large projects and quilts, and the included BERNINA Stitch Regulator ensures smooth, even free-motion stitching. Enjoy fast speeds of 1,100 stitches per minute for sewing and 1,000 for embroidery and a longer sewing time with the jumbo bobbin, which holds 40% more thread and reduces interruptions during long sessions.

The endless embroidery feature simplifies border designs with seamless alignment, and automatic thread cutting, jump stitch trims, and presser foot lift makes your projects even more efficient and easy. In addition, you can complete drag-and-drop stitch editing and take advantage of easy access to on-screen tutorials with the touchscreen.

~~\$8999~~ **\$2499**

Contact the store nearest to you to check out this certified pre-owned Bernina 830 LE w/ Embroidery Module and enjoy a 1-year mechanical warranty and 30-day unlimited ask warranty on all pre-owned machines today!

Bernina 880 Plus Crystal Edition

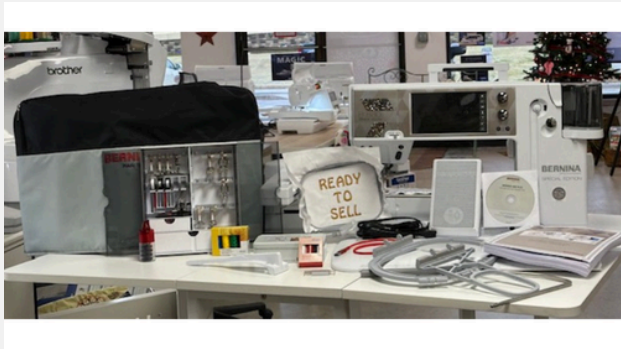

The **Bernina 880 PLUS Crystal Edition** is the ultimate sewing and embroidery machine, designed to bring luxury and precision to your projects. With its elegant shimmering faceplate adorned with genuine Swarovski crystals, this machine adds a touch of glamour to any sewing space. Perfect for quilters, embroiderers, and sewists, the B 880 PLUS offers a wide array of advanced features for professional results. The intuitive design makes it easy to use, while the powerful capabilities allow you to tackle both small and large projects with ease. Key features include:

- Exclusive Shimmering Faceplate adorned with real Swarovski Crystals
- Elegant White-and-Beige Geometric Pattern with crystal embellishments
- XL Trolley & XL Embroidery Module Bag for safe, stylish storage.
- Large Sewing & Embroidery Area with 12-inch extended freearm
- Jumbo Bobbin with 70% more capacity for fewer interruptions
- Precise Stitch Control with BERNINA Dual Feed and Stitch Regulator

~~\$15999~~ **\$8999**

Contact our **Clarksville** location at **(812) 283-8424** or visit our store at **914 Eastern Boulevard Clarksville, IN 47129** to learn more about the certified pre-owned Bernina 880 Plus Crystal Edition we have and enjoy a 1-year mechanical warranty and 30-day unlimited ask warranty on all pre-owned machines today!

Bernina Minimatic 807



This Certified Pre-Owned **Bernina Minimatic 807** is a great vintage find that you won't get in stores today. It has been around for a while, and its reliable durability is a testament to its great build. The 807 features a free arm, adjustable stitch length and width, and adjustable needle position. It stitches at approximately 1,100 stitches per minute and includes a built-in sewing lamp. The winder is self-releasing, and the machine weighs just 17.8 lbs. This model includes only one foot and 1 spool pin. For a full overview of the machine, the manual can be found in [Bernina's archives](#) here.

\$599.99

Contact our **Greenwood** location at **(317) 882-6672** or visit our store at **1035 North SR 135 Greenwood, IN 46142** to check out this certified pre-owned Bernina Minimatic 807 and enjoy a 1-year mechanical warranty and 30-day unlimited ask warranty on all pre-owned machines today!

Bernina 880 Sterling Edition



The **Bernina 880 Sterling Edition** is an advanced, innovative machine that is made to be as sleek as it is functional. This sewing and embroidery machine boasts an extended freearm for an XL embroidery field that expands the border of your creativity. There are several benefits built-in to the B880 Sterling Edition, too, and you can experience the convenient of the 7" color touchscreen with drag-and-drop, vertical scrolling, and swiping functions for heightened editing abilities. On this touchscreen, you will have access to an extensive stitch and design library with over 1,764 stitches, 400 high-quality embroidery designs, and 12 font styles as well as the Bernina Stitch Designer, which allows for the creation, editing, and storage of your own stitches.

You also get The Bernina Shape Designer, which makes duplicating and arranging embroidery designs easy, The Bernina Color Wheel, which coordinates designs to a color scheme, and the Distortion feature, which allows for a .01mm distortion to stitch patterns.

~~\$12999~~ **\$5999**

Contact our **Greenwood location at (317) 882-6672** or visit our store at **1035 North SR 135 Greenwood, IN 46142** to check out this certified pre-owned Bernina 880 Sterling Edition and enjoy a 1-year mechanical warranty and 30-day unlimited ask warranty on all pre-owned machines today!

Brother PQ1300



This certified pre-owned **Brother PQ1300** is a straight-forward, heavy-duty sewing machine meant to be there for you when you need it. It might not have any fancy technology, but this machine was a staple for the Brother brand for years before it was discontinued. It's a great machine for beginners or those looking for something simple. Contact us for more information about this hardy little mechanical sewing machine!

~~\$799~~ **\$399**

Contact the store nearest to you to check out this certified pre-owned Brother PQ1300 and enjoy a 1-year mechanical warranty and 30-day unlimited ask warranty on all pre-owned machines today!

Brother Innov-ís BQ2450

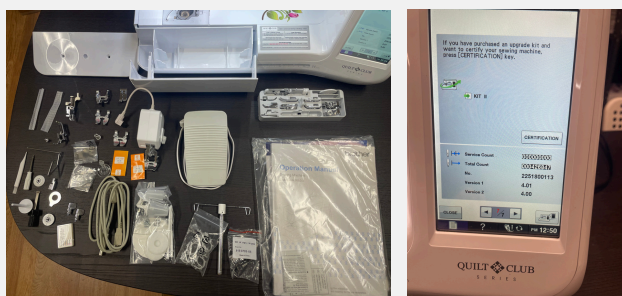

The Brother Innov-ís BQ2450 is the next level for those with a passion for sewing and quilting. It features a large 3.6" x 6.0" display with accessibility to view on-screen tutorials and the ability to control the machine with the intuitive on-screen icons. You'll also enjoy the convenience of having 561 sewing stitches (531 built-in, 30 on CD), 14 one-step auto-sized buttonhole styles and 5 sewing fonts, available at your fingertips. The BQ2450 Quilters Bundle includes a wide table for large projects, an open toe foot, a stitch in the ditch dual feed foot for more efficient feed movement, and a two-spool thread stand, which can hold up to two king thread spools. The machine has 10" LED lighting and a 5.0" x 11.25" workspace with the capacity to accommodate large quilts and projects. With the Automatic Height Adjustment (AHA) feature that helps ensure quality stitch length on all fabric thicknesses by keeping the presser foot pressure consistent and smoother sewing with longer feed dogs and J foot for powerful feeding and stitch consistency, the BQ2450 has everything you need.

~~\$4999.99~~ **\$2999**

Contact our Greenwood location at (317) 882-6672 or visit our store at 1035 North SR 135 Greenwood, IN 46142 to check out this certified pre-owned Brother Innov-ís BQ2450 and enjoy a 1-year mechanical warranty and 30-day unlimited ask warranty on all pre-owned machines today!

Brother NQ3500D



The Brother NQ3500D is a sewing and embroidery machine designed for creativity at every skill level. It features a large 6" x 10" embroidery area and provides ample space for detailed designs and bold personalization. With 173 built-in embroidery designs, including 35 Disney character patterns, plus 11 embroidery fonts and 140 frame pattern combinations, customization has more opportunity than ever. The vibrant 3.7" color LCD touchscreen allows easy on-screen editing, including resizing, rotating, repositioning, and combining designs without extra software.

On the sewing side, the NQ3500D offers 290 built-in stitches, an 8.3" workspace, and speeds up to 850 stitches per minute. Advanced features like the Automatic Height Adjuster, pivot function, automatic thread cutting, and USB connectivity make for the best possible performance and professional results.

~~\$2499~~ **\$1499**

Contact our Greenwood location at (317) 882-6672 or visit our store at 1035 North SR 135 Greenwood, IN 46142 to learn more about the certified pre-owned Brother NQ3500D we have and enjoy a 1-year mechanical warranty and 30-day unlimited ask warranty on all pre-owned machines today!

Brother Luminaire XP2



The **Brother Luminaire XP2** features all of the benefits of the original Luminaire, such as revolutionary StitchVision Technology that allows you to preview, audition, and edit your stitches and embroidery designs directly on your fabric. Plus, you get brilliant new quilting innovations and app-based features available from your mobile devices. However, this model in particular has had its software upgraded to the XP3, so you get even more features at a discounted price. It contains features such as:

- Over 1,500 built-in embroidery designs
- Stitch Tapering Function
- Ornate Long Stitch Technique
- Large Connect Designs
- Creative Yarn Couching
- 192 built-in Disney embroidery designs
- 10 decorative Disney stitches.
- Enhanced Innoveye Plus Technology
- 5 options of two-color quilting sash designs
- And more!

~~\$16999~~ **\$9999.99**

Contact the store nearest to you to check out this certified pre-owned Brother Luminaire XP2 and enjoy a 1-year mechanical warranty and 30-day unlimited ask warranty on all pre-owned machines today!

Brother Innov-ís 4000D

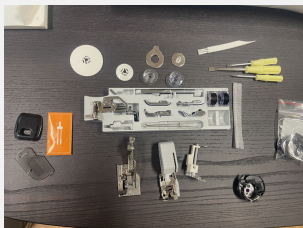
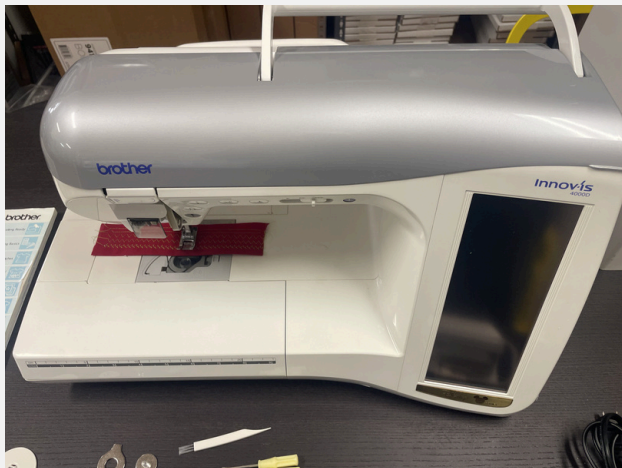

The **Brother Innov-ís 4000D** can sew or embroider at speeds up to 1,000 stitches per minute on a large embroidery field that measures nearly 12 x 7 inches. It features a triple lighting system and an oversized color LCD screen to select embroidery patterns, stitches, powerful editing feature tutorials and more. You can choose from a large selection of embroidery designs, which cover every style including classic, romantic, modern and so much more. Other features include:

- Revolutionary automatic needle threading system
- Maximum embroidery speed of 1000 stitches per minute
- Dual USB ports
- Maximum embroidery area 12" x 7"
- Large color LCD touch screen control panel

~~\$4999~~ **\$1299**

Contact the store nearest to you to check out this certified pre-owned Brother Innov-ís 4000D and enjoy a 1-year mechanical warranty and 30-day unlimited ask warranty on all pre-owned machines today!

Handi Quilter 8' Loft Frame w/ New Moxie Machine Head



The Handi Quilter 8' Loft Frame is one of Handi Quilter's top-of-the-line professional quilting frame systems. It is height-adjustable so that quilters can work ergonomically, and has two loading modes: high, for the standard "quilt in the trough" experience, and low, for better visibility when using rulers.

What is most exciting about this certified pre-owned 8' loft frame is that it comes with a brand new Moxie quilting machine head, with a stitch count of 0. The Moxie features 15 inches of free-motion quilting space with easy-to-use controls and up to 1,800 stitches per minute for your project. It has a full-color display, a ruler, open-toe foot, the high-speed rotary hook, and a larger-capacity M-class bobbin.

\$3995

Contact the store nearest to you to check out this certified pre-owned Janome 550E and enjoy a 1-year mechanical warranty and 30-day unlimited ask warranty on all pre-owned machines today!

Janome Travel Mate 30

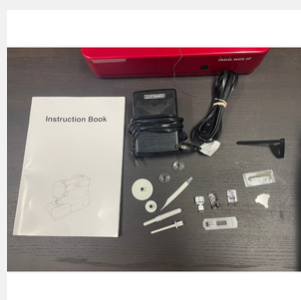

The Janome Travel Mate 30 is a computerized sewing machine that comes ready to sew and is full of user-friendly features and inclusions. Get convenience at your fingertips with a jam-proof, drop-in bobbin, an easy-to-read LCD display, a built-in needle threader, adjustable thread tension, and an automatic declutch bobbin winder. Next to the screen are an easy-to-reach locking stitch button, easy reverse button, and needle up-and-down button. The foot control allows you to control your sewing speed ergonomically, and the machine has a convertible free-arm for additional ease of use and customization.

With the certified pre-owned Janome Travel Mate 30, you get a 4-piece feed dog and stitching speeds of up to 820 stitches per minute that are customizable in width up to 5mm and length up to 4mm. Additionally, with 30 built-in stitches and a memory buttonhole, you have exactly what you need for most projects. This machine is built to be simple and effective; it's perfect for beginners or someone looking to simplify their sewing.

~~\$499~~ **\$349**

Contact the store nearest to you to check out this certified pre-owned Janome Travel Mate 30 and enjoy a 1-year mechanical warranty and 30-day unlimited ask warranty on all pre-owned machines today!

Pfaff Quilt Expression 4.0

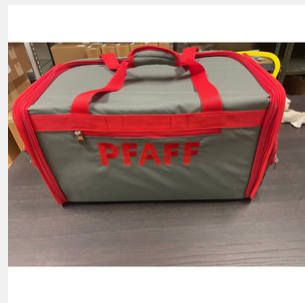

The Pfaff Quilt Expression 4.0 is a wonderful older machine that is ready to put in the work. It comes with a carrying case several beneficial features for sewists of all skill levels. The large stitch plate helps you to get precise spacing on your projects, and the IDT ensures that there is an even fabric feed from both the top and the bottom as things stay in place. It has 9 mm, high-quality stitches that can be mirrored and combined for endless stitch combinations, which is further obtained with the variety of utility and decorative stitches that are included. From original quilt stitches to antique quilt stitches that are only offered by PFAFF, creativity knows no bounds!

The machine features dual lights, automatic thread cutting, an electronic knee lift, and personal stitch settings that can be edited and saved to your liking. The sensoromatic buttonhole gives you professional buttonholes on any fabric, and the built-in sewing alphabet gives you a touch of personality for your projects. You get all of this and more with the certified pre-owned Pfaff Quilt Expression 4.0. Get yours today!

~~\$3499~~ **\$999**

Contact the store nearest to you to learn more about this certified pre-owned Pfaff Quilt Expression 4.0 and enjoy a 1-year mechanical warranty and 30-day unlimited ask warranty on all pre-owned machines today!

Singer 221-1 Featherweight



The Singer 221-1 Featherweight sewing machine is a rare vintage gem. While the 221 Singer Featherweight sewing machines were made between 1933-1969, this particular machine was one of 40,000 commissioned on November 18th, 1949. This electric sewing machine is one for the ages at 11 pounds and with total dimensions measuring at:

- 14 7/8 inches wide
- 7 1/4 inches deep
- 9 3/4 inches tall

It features a stitch regulator lever, the original 221-1 manual booklet, an embroidered Featherweight carrying case, and an electronic foot controller. The Singer Featherweight machines were advertised as being "light as a feather" in contrast to the cast iron machines that preceded it. With your certified pre-owned Singer 221-1, you will also get a foldable table with a cutout for the machine already fitted. Get yours today!

\$899

Contact our Greenwood location at (317) 882-6672 or visit our store at 1035 North SR 135 Greenwood, IN 46142 to learn more about the certified pre-owned Singer 221-1 Featherweight we have and enjoy a 1-year mechanical warranty and 30-day unlimited ask warranty on all pre-owned machines today!

Toyota Expert 851 ESP



The **Toyota Expert 851 ESP** comes equipped with a high-speeds of 1,200 SPM, unique belt drives for low noise and decreased vibrations, and a large stitch area that accommodates projects from sweatshirts to jackets to canvas bags and more. When combined with the convenience of the intuitive and accurate thread breakage sensor as well as an upper thread-keeper with a clutch to prevent thread slippage, the 851 ESP presents a wonderful machine for any embroidery project.

Dive into the history of embroidery with our certified pre-owned Toyota Expert 851 ESP embroidery machine that offers stellar thread power in a compact and easy-to-use design.

~~\$12999~~ **\$795 + FREIGHT**

Contact the store nearest to you to learn more about this certified pre-owned Toyota Expert 851 ESP and enjoy a 1-year mechanical warranty and 30-day unlimited ask warranty on all pre-owned machines today!

Viking Designer Topaz 50 w/ EMB MOD

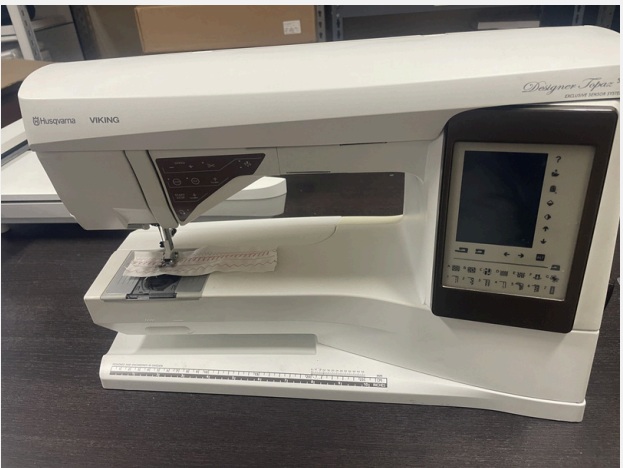

The **Husqvarna Viking Designer Topaz 50 w/ EMB MOD** is a sewing and embroidery machine that has several features that are great for customization and convenience. The Interactive Color Touch Screen allows you to navigate through various screens for embroidery, editing, and sewing with over 250 stitches. The Design Positioning feature lets you join large embroideries with perfect placement, while the Embroidery Design Editing and Save features gives you more control over your embroidery creativity. The large embroidery area allows you to stitch designs with just one hooping, and the generous sewing surface gives you more room for large projects.

This machine also features the unique **SENSOR SYSTEM™** technology that senses your fabric thickness for perfect, even feeding. In addition, the **SEWING ADVISOR®** feature optimizes your sewing by selecting the best settings for you and giving you on-screen advice. For even more convenience, the Automatic Jump Stitch Trim eliminates trimming time so that you can enjoy sewing and embroidery for longer.

~~\$3999~~ **\$1299**

Contact the store nearest to you to learn more about this certified pre-owned Viking Designer Topaz 50 w/ EMB MOD and enjoy a 1-year mechanical warranty and 30-day unlimited ask warranty on all pre-owned machines today!

Viking Epic Quilt 97



This Viking Epic Quilt 97 is a sewing and quilting machine offering a large working area over 12 inches (310mm) to the right of the needle. The Integrated Dual Feed Technology gives you smooth, even fabric feeding from both the top and bottom for multiple layers of fabric or specialty materials. With sewing projection, you can preview your stitching design before sewing & use adjustable grids and angles to align your stitches. With Stitch Creator™, you can create custom 9mm stitches or edit existing ones. This machine is complete with the included accessory kit, which comes with:

- An extension table
- Free-motion ruler foot
- Quilt binder + presser foot
- A rotating self-heating cutting mat
- Rotary cutting tools
- A ruler set
- And more

~~\$13999.99~~ **\$8499.99**

Contact our Greenwood location at (317) 882-6672 or visit our store at 1035 North SR 135 Greenwood, IN 46142 to check out this certified pre-owned Viking Epic Quilt 97 and enjoy a 1-year mechanical warranty and 30-day unlimited ask warranty on all pre-owned machines today!

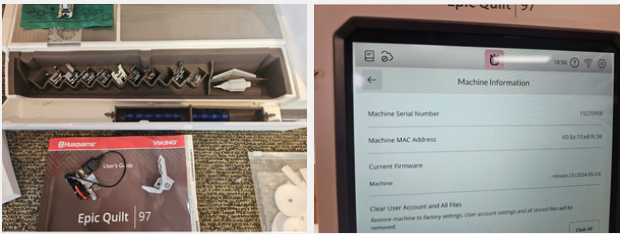

Viking Huskylock 700



Being Serviced - Available Soon!

The Husqvarna Viking Huskylock 700 is a serger that offers a range of features and functions for sewing enthusiasts. Designed with precision and attention to detail, this machine is known for its reliability and performance. One notable feature of the Husqvarna Huskylock 700 is its ability to sew a variety of stitches, including straight stitches, zigzag stitches, and decorative stitches. This versatility allows users to create a wide range of projects, from simple hemming to intricate embroidery.

With user-friendly controls and a clear, informative display, this machine makes sewing enjoyable and hassle-free. It also features a built-in needle threader, making threading the needle quick and effortless. The Husqvarna Huskylock 700 is built to last, thanks to its high-quality construction and durable materials. Overall, the Husqvarna Huskylock 700 is a dependable serger that offers a range of features and functions for sewing enthusiasts. Its versatility, ease of use, and durability make it a valuable tool for various sewing projects.

~~\$499~~ **\$199**

Contact the store nearest to you to learn more about this certified pre-owned Viking Huskylock 700 and enjoy a 1-year mechanical warranty and 30-day unlimited ask warranty on all pre-owned machines today!



Viking Designer SE w/ Embroidery



This Viking Designer SE Plus Embroidery offers users tons of features for convenience and user-friendliness across the board. From the interactive Designer screen with a 3D view that works with a stylus or a USB mouse and gives you access to stitches, functions, and information to the LED lighting, you have it all. On screen arrows show the needle stop position. You can stop sewing with the needle down and the Sensor System automatically raises the presser foot to a pivot position, which is a perfect floating position for the thickness of your fabric. With 1000+ stitches available in the machine and the ability to resize your design as the machine automatically recalculates the number of stitches, creativity and customization is easy. In addition to the built-in stitches, the Designer SE has USB connectivity to allow you to transfer designs to and from your computer.

This machine includes an embroidery module.

\$999.99

Contact our Westport location at (502) 412-6040 or visit our store at 10494 Westport Road Louisville, KY 40241 to check out this certified pre-owned Viking Epic Quilt 97 and enjoy a 1-year mechanical warranty and 30-day unlimited ask warranty on all pre-owned machines today!